

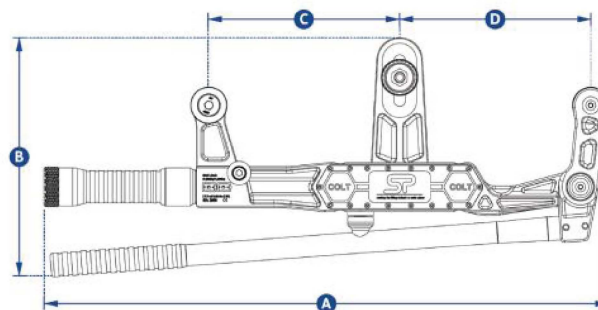

Clamp On Line Tensionmeter (COLT)



- Lightweight wire rope tension meter for fast and accurate measurement of tensions up to 5,000kg or 11,000lb and up to 25mm or 1in diameter.
- Constructed from aerospace grade aluminum.
- Unlimited wire rope calibration database via Android or iOS app.
- Built-in magnetic smart device holder for on board display.
- Main swivel joints fitted with high-quality bearings.
- Lever ratio of 5.3:1 allows effortless, safe, clamping onto pre-tensioned wire ropes.
- Wireless Bluetooth 4.2 enabling operator to stand a safe distance away, up to 100m or 328ft.
- Quick intuitive adjustable center sheave makes changing wire rope sizes fast and easy.
- No easily broken external antenna.
- High waterproof resistant design IP67 or NEMA6 for all weather use.
- Long battery life of 1000 hrs operational time.
- As the library of wire rope diameters and constructions is increased each app user will benefit when they update free of charge.

| | |
|---------------------------|---|
| Part Numbers | COLT5T |
| SP | |
| Crosby | 2789000 |
| Max Load | 5,000 kg |
| | 11,000 lb |
| Resolution | 10 kg |
| | 20 lb |
| Units | kilograms, pounds, metric tons and kilonewtons |
| Min Wire Rope Ø | Ø5 mm |
| | Ø3/16" |
| Max Wire Rope Ø | Ø25 mm |
| | Ø1" |
| Max Line Reduction | 5 mm with a Ø10 mm wire rope |
| | 7/32" with a Ø3/8" wire rope |
| Wire Rope Database | Infinite via Android or iOS app |
| Weight | 3.5 kg |
| | 7.7 lb |
| Battery Type | 2 x 'C' cell batteries |
| Battery Life | 1000 hours Bluetooth transmission time |
| Operating Temp. | -25°C to +70°C / -13°F to +158°F |
| Protection | IP67 / NEMA6 |
| Accuracy | ±3% of full scale if wire rope Ø and construction known |
| Communication | Bluetooth 4.2 |
| Dimension A | 589 mm |
| | 23.2" |
| Dimension B | 254 mm |
| | 10" |
| Dimension C | 200 mm |
| | 7.9" |
| Dimension D | 200 mm |
| | 7.9" |

Specifications assume COLT used on a wire rope with a fixed and flexible end.

Optional for purchase:

Calibration verification tool (CVT)

SP - SA507 Crosby 2789225

In order to ensure the measurements of the COLT are as accurate as possible, Crosby SP supplies a calibration verification rod.



LOAD MONITORING

Bolt On Line Tensionmeter (BOLT)

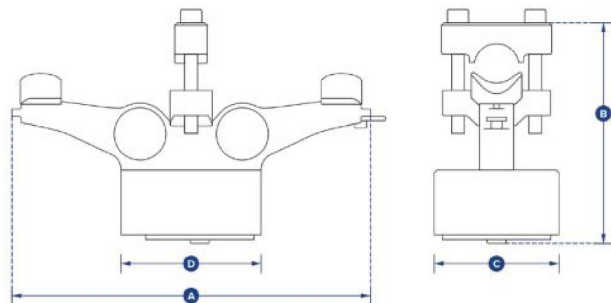

2

- Constructed from aerospace-grade aluminum.
- Designed to be mounted in a permanent position on wire rope or cable to accurately monitor measurements of tension up to 10,000 kg or 20,000lb and up to 32mm or 1.25in diameter.
- Proprietary 2.4 GHz wireless.
- Leading wireless range of 1000m/3280ft when connected to SW-HHP, enabling you to read up to four loadcells simultaneously.
- Unlimited range when connected to BaseStation to monitor remotely.
- Will provide reduced site visits, improve decision making and safely monitor line tensions from any distance from anywhere in the world.
- Unrivaled battery life of 1200 hrs.
- Multiple drop tested from 3 meters or 10 feet.
- Internal antenna.
- Remote on/off from handheld display or software.

| | |
|------------------------|--|
| Part Numbers | BOLT10T |
| SP | |
| Crosby | 2789573 |
| Max Load | 10 t |
| | 22000 lb |
| Resolution | 0.01 t |
| | 20 lb |
| Units | kilograms, pounds, metric tons and kilonewtons |
| Min Wire Rope Ø | 16 mm |
| | 5/8" |
| Max Wire Rope Ø | 32 mm |
| | 1 1/4" |
| Weight | 2.1 kg |
| | 4.6 lb |
| Battery Type | 4 x 'AA' cell batteries |
| Battery Life | 1200 hours |
| Operating Temp. | -10°C to +50°C / 14°F to +122°F |
| Protection | IP67 / NEMA6 |
| Accuracy | Typically 3-5% |
| Communication | 2.4 GHz |
| Dimension A | 259 mm |
| | 10.20" |
| Dimension B | 159.1 mm |
| | 6.26" |
| Dimension C | 89 mm |
| | 3.50" |



CableSafe

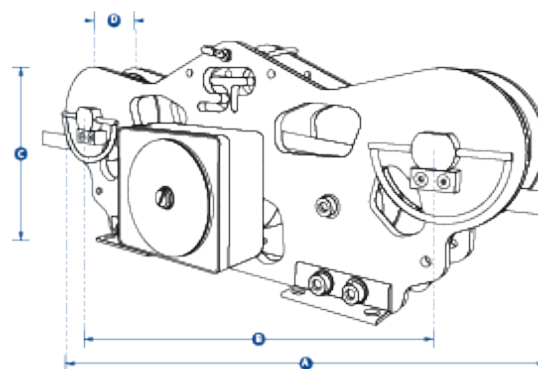

- Simple to use and set up.
- Remote monitoring using smart phone via Bluetooth.
- Rapid tension force measurement - Up to 600m or 1968ft per minute.
- Able to be used in all weather and air quality conditions.
- Providing up to 500 hours battery life.
- Easy to install and replace batteries (4 x AA standard alkaline).
- Fully constructed from aerospace-grade aluminum with anodized finish.
- Five-wheel design, improving accuracy.
- Blue anodized side plates.
- Linchpins are fitted to the top sheave pins, making wire rope installation quick and simple.
- Maintenance free heavy duty bearings.
- Compatible with a wide range of synthetic rope/electrical cable diameters – 4-30mm or 5/32 in – 1 3/16 in.
- IP67 ingress protection or NEMA6 – heavy protection against dust and rain.
- Design validated by FEA.

In addition to the TIMH range, the CableSafe® is the continued evolution of Crosby Straightpoint's running line tensiometers. When used in the field, it will allow the user to monitor tension with exceedingly high levels of accuracy, which ensures rope/cables do not become overstretched or break.

When using a capstan winch to unwind electrical cable from a reel/spool, you will be able to integrate the CableSafe within this set-up to ensure that it is being pulled at a safe tension level. This helps the line maintain its transmissions capability, prevent it becoming a fire hazard risk, and it also stops the need of furthering work in order to remove and replace it. The contractor is gifted with decreased liability, dramatically increasing peace of mind.

| Part Numbers SP | CableSafe | CableSafe-WD |
|-------------------------------------|---------------------------------|---------------|
| Crosby | 2789219 | 2789399 |
| Capacity | 10 t | 10 t |
| | 22000 lb | 22000 lb |
| Resolution | 0.01 t | 0.01 t |
| | 20 lb | 20 lb |
| Synthetic Rope / Electrical Cable Ø | 4-19 mm | 9.5-30 mm |
| | 5/32"- 3/4" | 3/8"- 1 3/16" |
| Weight | 4.5 kg | 8 kg |
| | 10 lb | 17.6 lb |
| Battery Type | 4 x AA Alkaline | |
| Battery Life | 500 hours | |
| Operating Temp. | -10°C to +50°C / 14°F to 122°F | |
| Accuracy | ±2% of full scale | |
| Range | Bluetooth 100 meters / 328 feet | |
| Protection | IP67 / NEMA6 | |
| Maximum Speed | 600 m per minute | |
| | 1,968 ft per minute | |
| Dimension A | 422 mm | 422 mm |
| | 16.61" | 16.61" |
| Dimension B | 328 mm | 328 mm |
| | 12.91" | 12.91" |
| Dimension C | 152 mm | 152 mm |
| | 5.98" | 5.98" |
| Dimension D | 36.5 mm | 50.5 mm |
| | 1.43" | 2" |

Using CableSafe on cable pulls reduces liabilities on cable installations, making it ideal for the following applications:

- Measure tension when pulling electrical cables – protect against fractures or elongation
- Measuring tension on synthetic rope when erecting delicate structures using gin poles and capstan winch

Another example of best use is during the installation of cell phone towers or similar delicate structures. The product helps ensure structure-to-ground ropes which are connected to a gin pole and pulley system. Avoid the unknown through accurate monitoring, especially when risks are high.



LOAD MONITORING

Running Line Dynamometer

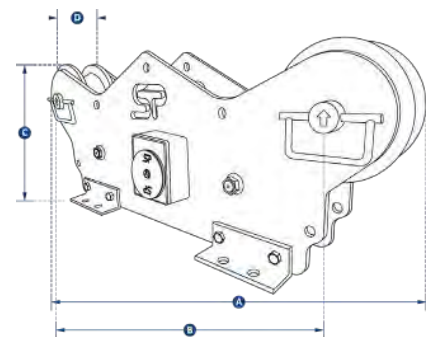
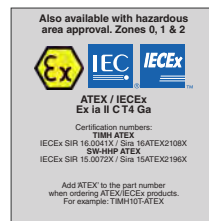

2

The TIMH range is a wireless running line tensiometer or RLTM built with dockside, marine, offshore, towage, and salvage applications in mind.

- Fully constructed from corrosion-resistant stainless steel.
- Large range of capacities to 150t and wire rope diameters up to 89mm or 3½ in.
- Measures tension force at speeds up to 20m/min or 65ft/min.
- Five-wheel design, improving accuracy.
- Industry leading battery life of 1200 hrs (wireless).
- Maintenance-free heavy duty bushes.
- Options for lineout and speed available.
- Software available to data log and monitor or analog outputs.
- Cabled system or wireless bluetooth option are available and is supplied with a free HHP app for iOS and Android.
- IP67 or NEMA6 Loadpin.
- Design validated by FEA.

| Part Numbers SP | MTIMH10TRD | TIMH10TRD | TIMH25TRD | TIMH56TRD | TIMH80TRD | TIMH150TRD | |
|--------------------|--|--------------|-------------|-----------|-----------------|------------------|-------------|
| Crosby | 2789054 | 2789136 | 2789139 | 2789144 | 2789146 | 2789270 | |
| Capacity | (te) | 10 | 10 | 25 | 56 | 80 | 150 |
| | (lb) | 22,000 | 22,000 | 55,000 | 123,200 | 176,000 | 330,000 |
| Resolution | (te) | 0.01 | 0.01 | 0.02 | 0.05 | 0.1 | 0.2 |
| | (lb) | 20 | 20 | 50 | 100 | 200 | 500 |
| Wire Rope Ø | (mm) | 4-19 | 13-19 | 16-26 | 28-38 | 40-52 | 52-89 |
| | (in) | 5/32" - 3/4" | 1/2" - 3/4" | 5/8" - 1" | 1 1/8" - 1 1/2" | 1 5/8" - 2" | 2" - 3 1/2" |
| Weight | (kg) | 9 | 90 | 86 | 81 | 76 | 230 |
| | (lb) | 20 | 198 | 190 | 179 | 168 | 506 |
| Battery Type | 4 x AA Alkaline | | | | | | |
| Battery Life | Wireless version 1200 hours continuous | | | | | | |
| Operating Temp. | -10°C to +50°C / 14°F to 122°F | | | | | | |
| Accuracy | ±2% of full scale | | | | | | |
| Frequency | 2.4 GHz | | | | | | |
| System Range (max) | 700 meters / 2,300 feet | | | | | | |
| Data Rate | 3 updates per second | | | | | | |
| Protection | IP67 / NEMA6 | | | | | | |
| Maximum Speed | 50 m per minute | | | | | 20 m per minute | |
| | 164 ft per minute | | | | | 65 ft per minute | |
| Line out and speed | via SW-MWLC software | | | | | | |
| Dimension A | (mm) | 422 | 865 | 865 | 865 | 865 | 1250 |
| | (in) | 16.62 | 34.05 | 34.05 | 34.05 | 34.05 | 49.21 |
| Dimension B | (mm) | 328 | 674 | 674 | 674 | 674 | 1050 |
| | (in) | 12.9 | 26.53 | 26.53 | 26.53 | 26.53 | 41.33 |
| Dimension C | (mm) | 152 | 324 | 324 | 324 | 324 | 416 |
| | (in) | 5.98 | 12.75 | 12.75 | 12.75 | 12.75 | 16.37 |
| Dimension D | (mm) | 36 | 111 | 111 | 111 | 111 | 153 |
| | (in) | 1.4 | 4.37 | 4.37 | 4.37 | 4.37 | 6.02 |